

AOC



LCD Monitor User Manual

U27U2DP

Safety	1
National Conventions	1
Power	2
Installation	3
Cleaning	4
Other	5
Setup	6
Contents in Box	6
Setup Stand & Base	7
Adjusting Viewing Angle	8
Wall Mounting	9
Connecting the Monitor	10
DisplayPort multi-stream transport (MST) mode	12
HDR	13
KVM	14
Adjusting	15
Hotkeys	15
OSD Setting	16
Luminance	17
Color Setup	18
Picture Boost	19
OSD Setup	20
PIP Setting	21
Game Setting	22
Extra	23
Exit	24
LED Indicator	25
Troubleshoot	26
Specification	27
General Specification	27
Preset Display Modes	29
Pin Assignments	30
Plug and Play	31

Safety

National Conventions

The following subsections describe notational conventions used in this document.

Notes, Cautions, and Warnings

Throughout this guide, blocks of text may be accompanied by an icon and printed in bold type or in italic type. These blocks are notes, cautions, and warnings, and they are used as follows:



NOTE: A NOTE indicates important information that helps you make better use of your computer system.



CAUTION: A CAUTION indicates either potential damage to hardware or loss of data and tells you how to avoid the problem.



WARNING: A WARNING indicates the potential for bodily harm and tells you how to avoid the problem. Some warnings may appear in alternate formats and may be unaccompanied by an icon. In such cases, the specific presentation of the warning is mandated by regulatory authority.

Power

 The monitor should be operated only from the type of power source indicated on the label. If you are not sure of the type of power supplied to your home, consult your dealer or local power company.

 The monitor is equipped with a three-pronged grounded plug, a plug with a third (grounding) pin. This plug will fit only into a grounded power outlet as a safety feature. If your outlet does not accommodate the three-wire plug, have an electrician install the correct outlet, or use an adapter to ground the appliance safely. Do not defeat the safety purpose of the grounded plug.

 Unplug the unit during a lightning storm or when it will not be used for long periods of time. This will protect the monitor from damage due to power surges.

 Do not overload power strips and extension cords. Overloading can result in fire or electric shock.

 To ensure satisfactory operation, use the monitor only with UL listed computers which have appropriate configured receptacles marked between 100-240V AC, Min. 5A.

 The wall socket shall be installed near the equipment and shall be easily accessible.

Installation

! Do not place the monitor on an unstable cart, stand, tripod, bracket, or table. If the monitor falls, it can injure a person and cause serious damage to this product. Use only a cart, stand, tripod, bracket, or table recommended by the manufacturer or sold with this product. Follow the manufacturer's instructions when installing the product and use mounting accessories recommended by the manufacturer. A product and cart combination should be moved with care.

! Never push any object into the slot on the monitor cabinet. It could damage circuit parts causing a fire or electric shock. Never spill liquids on the monitor.

! Do not place the front of the product on the floor.

! If you mount the monitor on a wall or shelf, use a mounting kit approved by the manufacturer and follow the kit instructions.

! Leave some space around the monitor as shown below. Otherwise, air-circulation may be inadequate hence overheating may cause a fire or damage to the monitor.

! To avoid potential damage, for example the panel peeling from the bezel, ensure that the monitor does not tilt downward by more than -6.5 degrees. If the -6.5 degree downward tilt angle maximum is exceeded, the monitor damage will not be covered under warranty.

See below the recommended ventilation areas around the monitor when the monitor is installed on the wall or on the stand:

Installed with stand

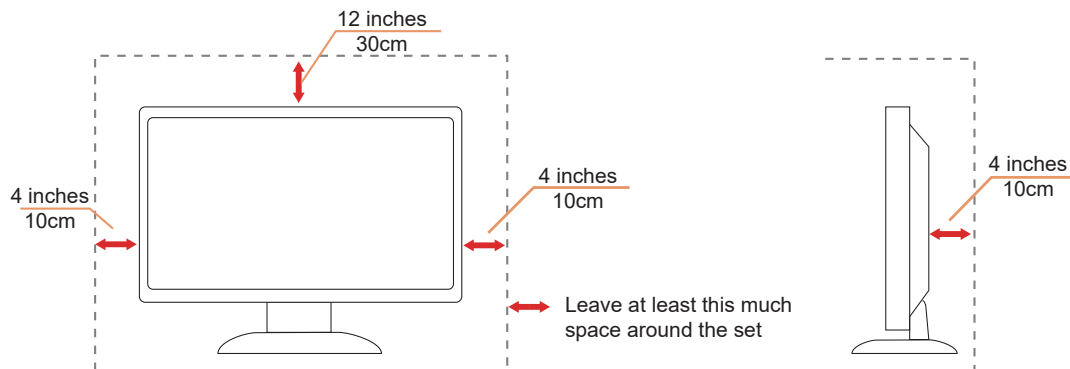

Cleaning

! Clean the cabinet regularly with a water-dampened, soft cloth.

! When cleaning use a soft cotton or microfiber cloth. The cloth should be damp and almost dry, do not allow liquid into the case.



! Please disconnect the power cord before cleaning the product.

Other

 If the product is emitting a strange smell, sound or smoke, disconnect the power plug IMMEDIATELY and contact a Service Center.

 Make sure that the ventilating openings are not blocked by a table or curtain.

 Do not engage the LCD monitor in severe vibration or high impact conditions during operation.

 Do not knock or drop the monitor during operation or transportation.

 The power cords shall be safety approved. For Germany, it shall be H03VV-F, 3G, 0.75 mm², or better. For other countries, the suitable types shall be used accordingly.

 Excessive sound pressure from earphones and headphones can cause hearing loss. Adjustment of the equalizer to maximum increases the earphones and headphones output voltage and therefore the sound pressure level.

Setup

Contents in Box

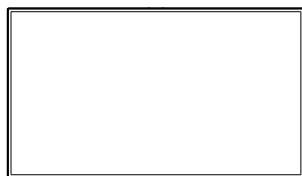

Monitor



Quick Start



Warranty Card

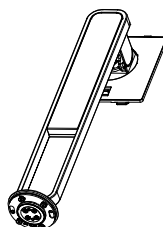

Stand

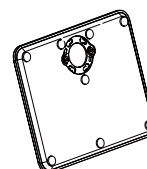

Base



Power Cable



HDMI Cable



DisplayPort
Cable



USB C-C
Cable



USB C-A
Cable



USB C-C/A
Cable

* Not all signal cables will be provided for all countries and regions. Please check with the local dealer or AOC branch office for confirmation.

Setup Stand & Base

Please setup or remove the base following the steps as below.

Setup:

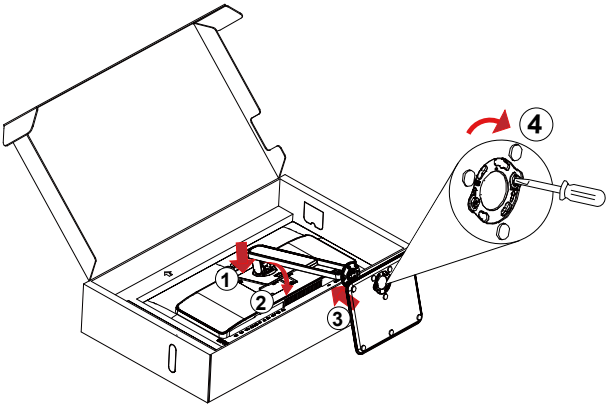

Remove:

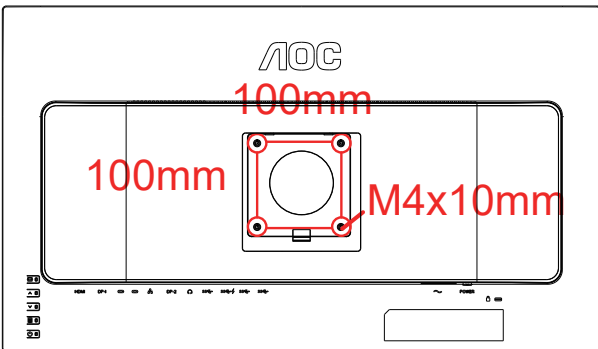
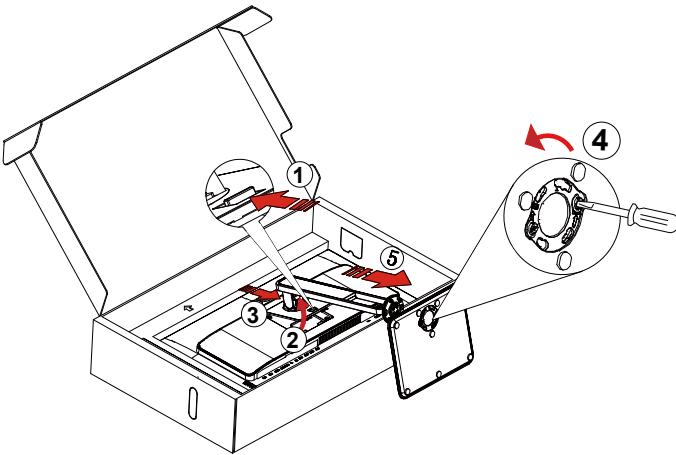

Specification for wall-mounted screw: M4*10 mm Specification for base screw: M6*13 mm (effective thread 5.5 mm)

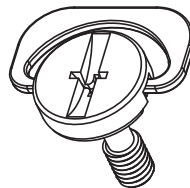
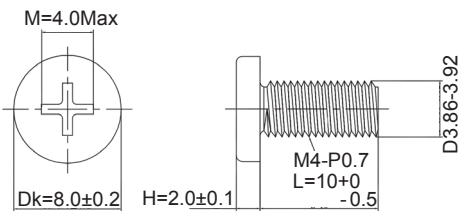

Adjusting Viewing Angle

For optimal viewing it is recommended to look at the full face of the monitor, then adjust the monitor's angle to your own preference.

Hold the stand so you will not topple the monitor when you change the monitor's angle.

You are able to adjust the monitor as below:

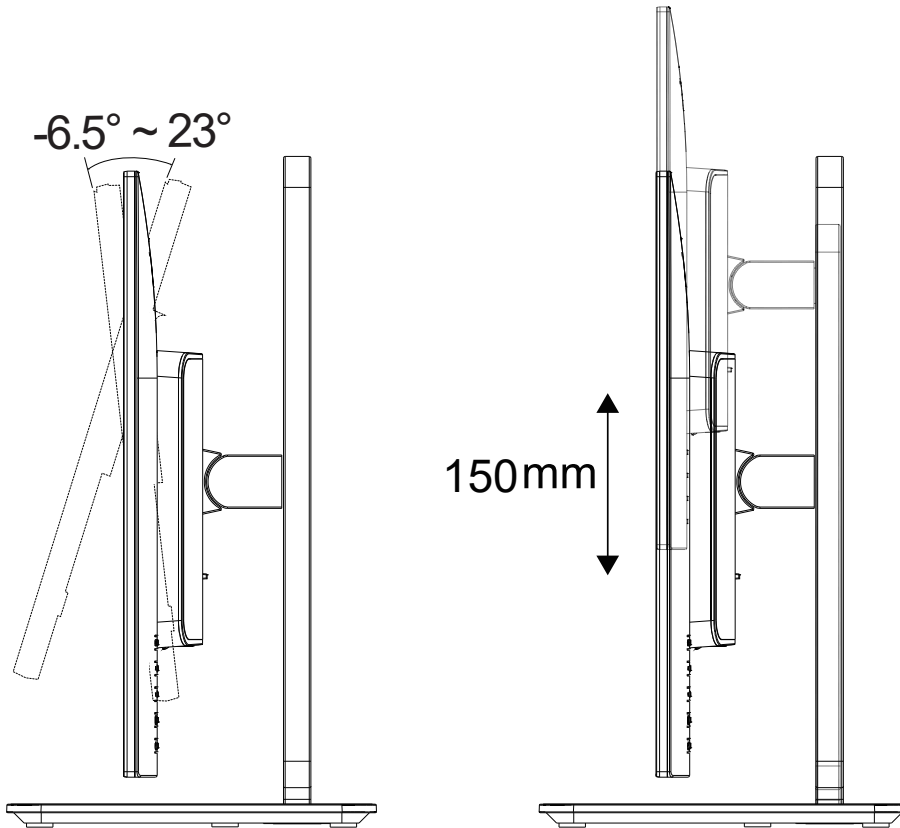

NOTE:

Do not touch the LCD screen when you change the angle. Touching the LCD screen may cause damage.

Warning:

1. To avoid potential screen damage, such as panel peeling, ensure that the monitor does not tilt downward by more than -6.5 degrees.
2. Do not press the screen while adjusting the angle of the monitor. Grasp only the bezel.

Wall Mounting

Preparing to Install An Optional Wall Mounting Arm.

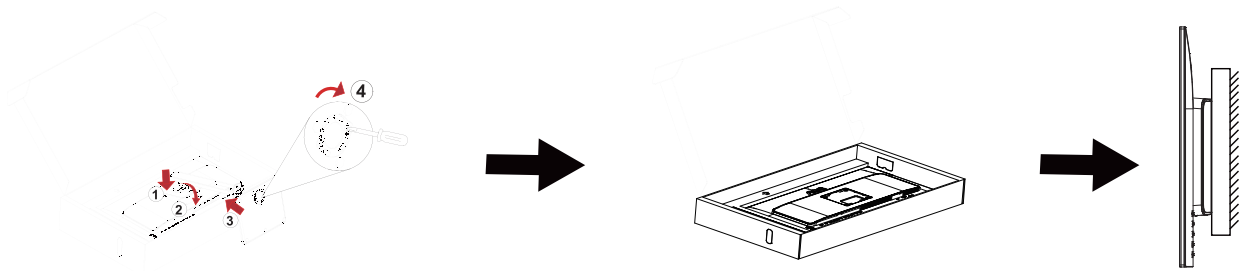

This monitor can be attached to a wall mounting arm you purchase separately. Disconnect power before this procedure. Follow these steps:

1. Remove the base.
2. Follow the manufacturer's instructions to assemble the wall mounting arm.
3. Place the wall mounting arm onto the back of the monitor. Line up the holes of the arm with the holes in the back of the monitor.
4. Reconnect the cables. Refer to the user's manual that came with the optional wall mounting arm for instructions on attaching it to the wall.



Noted: VESA mounting screw holes are not available for all models, please check with the dealer or official department of AOC.

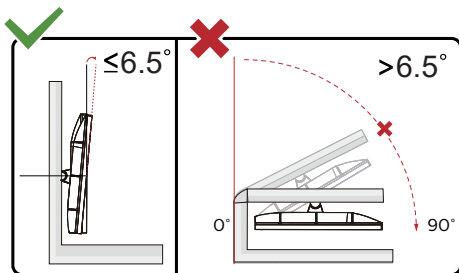

* Display design may differ from those illustrated.

Warning :

1. To avoid potential screen damage, such as panel peeling, ensure that the monitor does not tilt downward by more than -6.5 degrees.
2. Do not press the screen while adjusting the angle of the monitor. Grasp only the bezel.

Connecting the Monitor

Cable Connections In Back of Monitor:

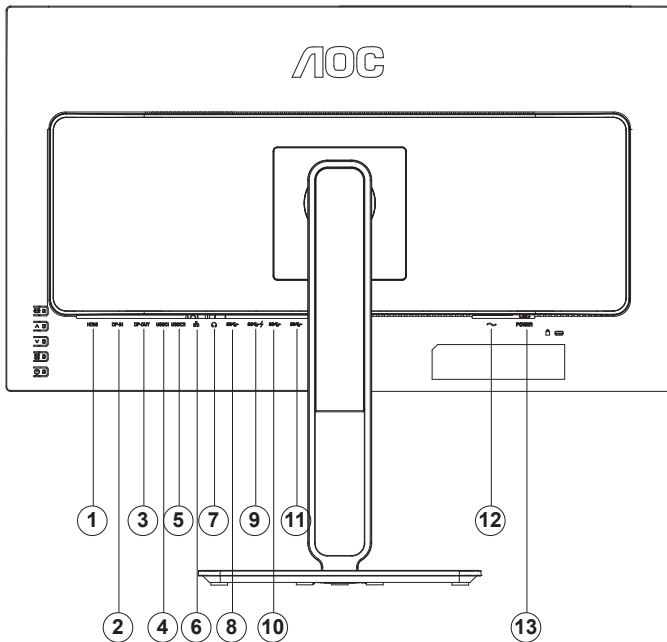

1. HDMI
2. DisplayPort (input)
3. DisplayPort (output)
4. USB-C1 (DisplayPort Alt mode, maximum PD90W)
5. USB-C2 (USB upstream, maximum PD15W)
6. RJ45 (network connector)
7. Earphone
8. USB3.2 Gen2+ downstream
9. USB3.2 Gen2 downstream+charging
10. USB3.2 Gen2+ downstream
11. USB3.2 Gen2+ downstream
12. Power
13. Power Strict

Connect to PC

1. Connect the power cord to the back of the display firmly.
2. Turn off your computer and unplug its power cable.
3. Connect the display signal cable to the video connector on your computer.
4. Plug the power cord of your computer and your display into a nearby outlet.
5. Turn on your computer and display.

If your monitor displays an image, installation is complete. If it does not display an image, please refer Troubleshooting.

To protect equipment, always turn off the PC and LCD monitor before connecting.

Connect the USB C-C Cable:

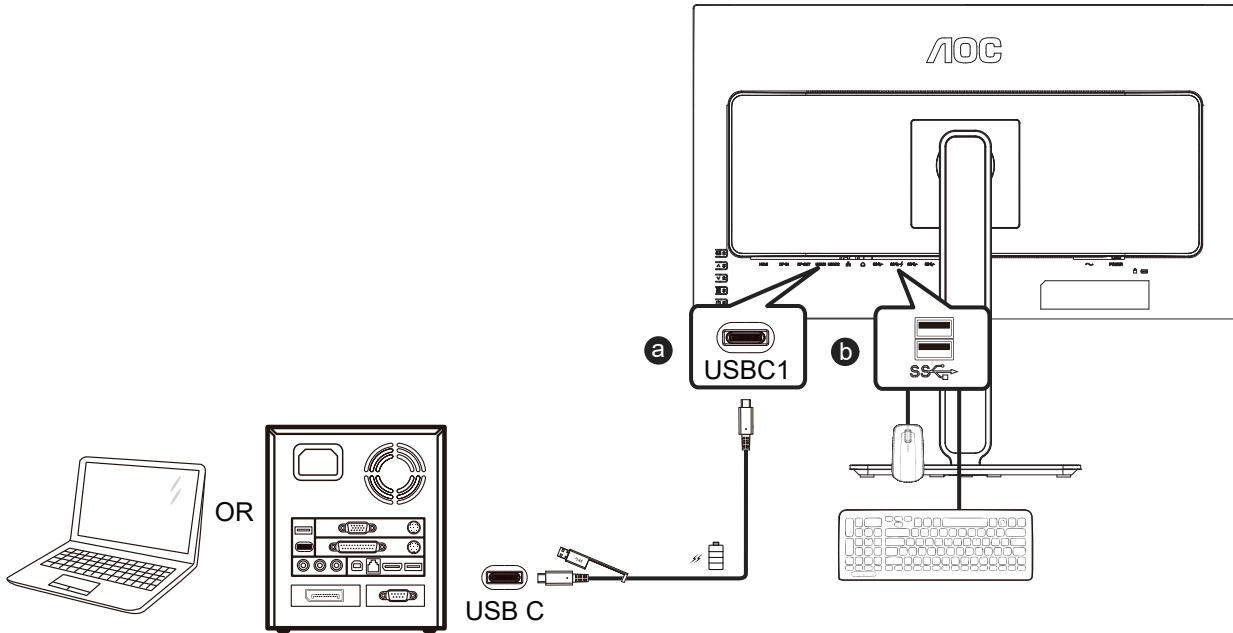

Connect the USB C-A Cable:

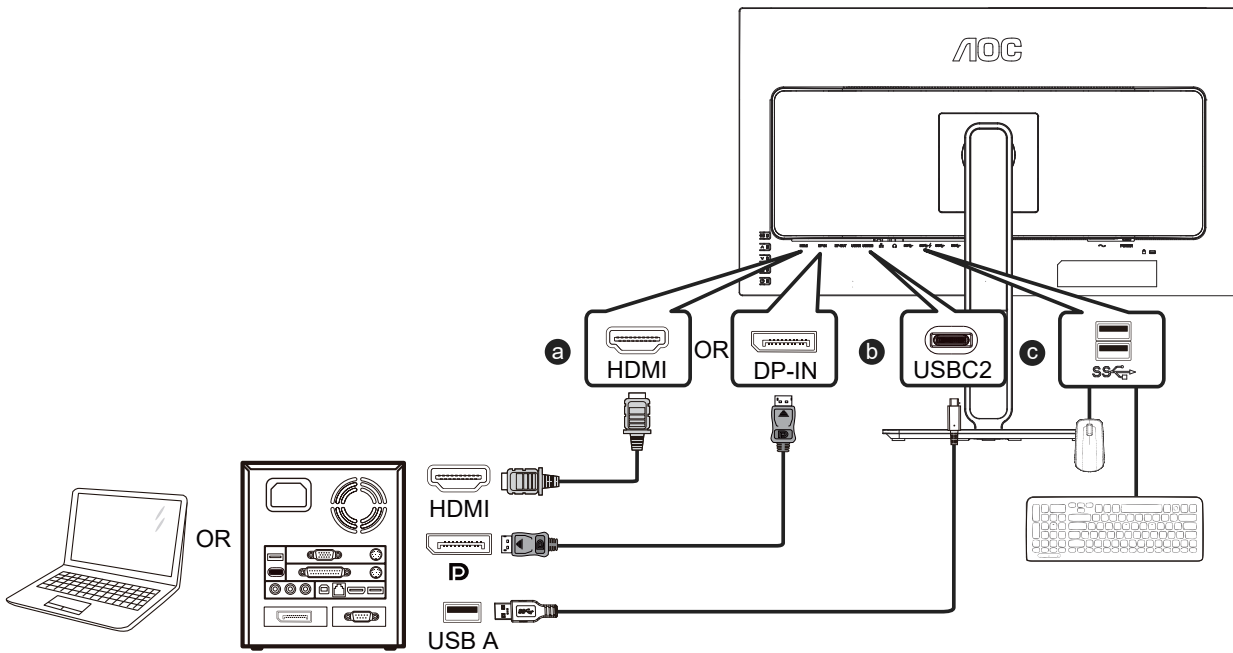

Note:

- 1). Before using the RJ45 Ethernet connector, please visit the official website <https://www.aocmonitor.com.cn>, go to the U27U2DP product page -> Data Download and download the Windows driver for the RJ45 Ethernet connector.
- 2). The multi-function USB-C connector (USB-C1) is used for screen projection, and mobile devices need to support USB-C (DP Alt) function.
- 3). The USB-C2 connector has the function of USB upstream data transmission, and the USB-C to USB-C cable or USB-C to USB-A cable with data transmission function can be used to connect the USB-C2 connector of the monitor to the computer, so that the USB-A connector (USB downstream connector) can transmit data. Without this connection, the USB-C2 connector can only supply external power, and the maximum output power is 15W.
- 4). The USB-A connector (USB downstream connector) may transmit data only when the monitor and the computer are connected by a USB-C to USB-C cable or USB-C to USB-A cable with data transmission function, such as connecting a mouse, keyboard, USB flash drive, etc. Without this connection, the USB-A connector can only supply external power. It is recommended to use a USB-A connector to connect a mouse, keyboard, and/or other devices, thus saving computer connectors.

DisplayPort multi-stream transport (MST) mode

This product supports DisplayPort multi-stream transport (MST) mode, and realizes daisy-chain connection of multiple monitors through a DisplayPort (output) connector.

To daisy-chain the monitor, follow these steps:

1. Confirm whether the computer graphics card (GPU) supports DSC and has DSC enabled on the graphics card.
2. Connect the monitor to the computer or mobile device through the DisplayPort (input) or USB-C1 connector, and connect this monitor to the second monitor through the DisplayPort (output) connector.
3. Adjust the OSD menu and select the input signal source as DP or USB-C1: press the menu key -> Other -> Input Selection and set it as DP or USB-C1.
4. The MST feature will be automatically turned on.

Note: If you need to manually adjust the MST feature, please select OSD Settings -> MST. If the input is an HDMI signal source, the MST feature is Off by default and cannot be adjusted.

Multi-stream transport (MST) through the DisplayPort

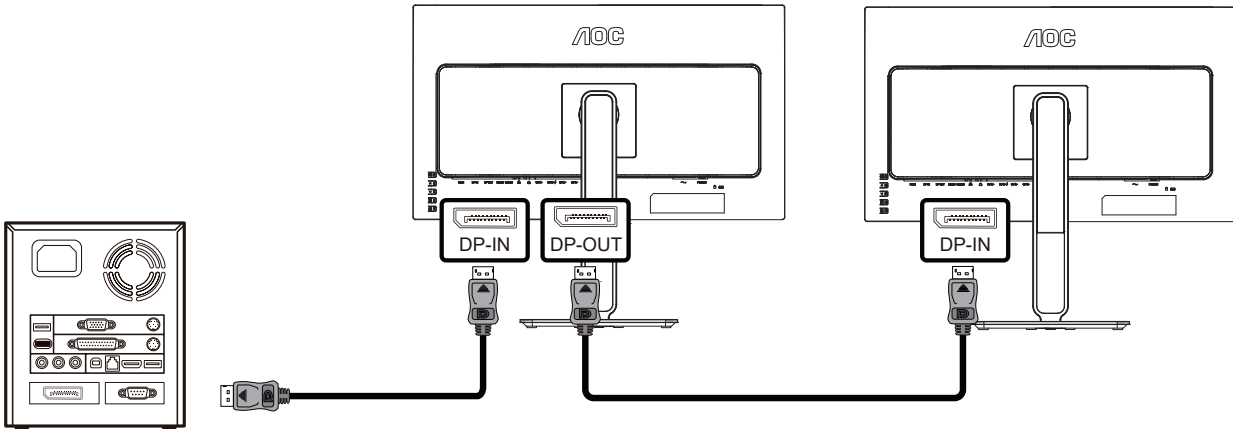

Multi-stream transport (MST) through the USB-C

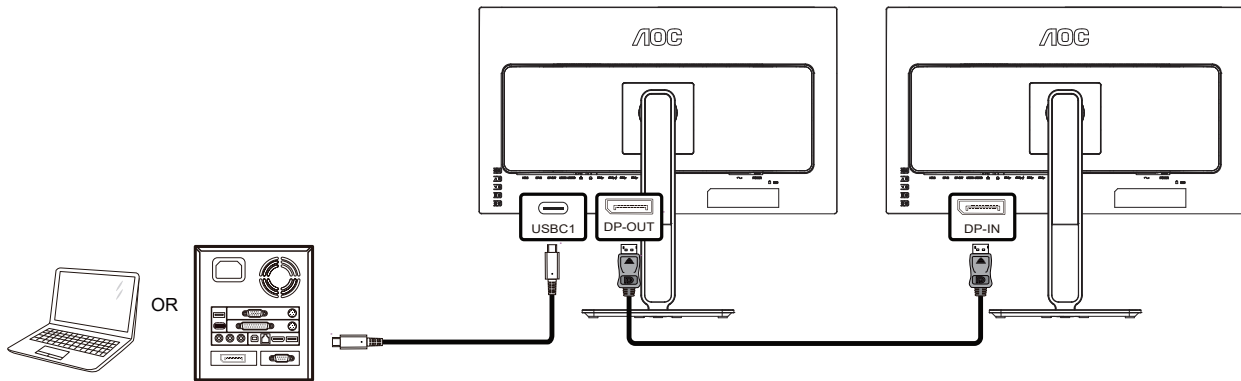

Maximum resolution of the MST signal source	Maximum resolution of an external monitor	Maximum number of external monitors that can be supported at maximum resolution
3840×2160@60Hz	3840×2160@60Hz	2

Note:

- 1). The DP multi-stream transport (MST) mode must use a graphics card supporting DSC, and the DP(HBR3) or USB-C (DisplayPort Alt) (HBR3) signal is input, so that multiple monitors can be daisy-chained through the DP (output) connector.
- 2). The maximum resolution of external monitors can reach 3840×2160@60Hz only when the computer graphics card (GPU) supports DSC, and DSC has been enabled on the graphics card, and the number of external monitors does not exceed the limit in the above table.
- 3). The maximum number of external monitors that can be connected will vary depending on the performance of the graphics card (GPU). It is highly recommended to use a discrete graphics card. The maximum number of monitors supported includes the first monitor directly connected to the computer. If the first monitor is connected to a laptop, the number may vary. Please consult the graphics card manufacturer and update the graphics card driver frequently.

HDR

It is compatible with input signals in HDR10 format.

The display may automatically activate the HDR function if the player and content are compatible. Please contact the device manufacturer and the content provider for information on the compatibility of your device and content. Please select "OFF" for the HDR function when you have no need for automatical activation function.

Display Settings:

- Enter the "Display Settings," and select the resolution – 3440x1440, and HDR on.
- Change to select the resolution – 3440x1440 (if available) to achieve the best HDR effects.

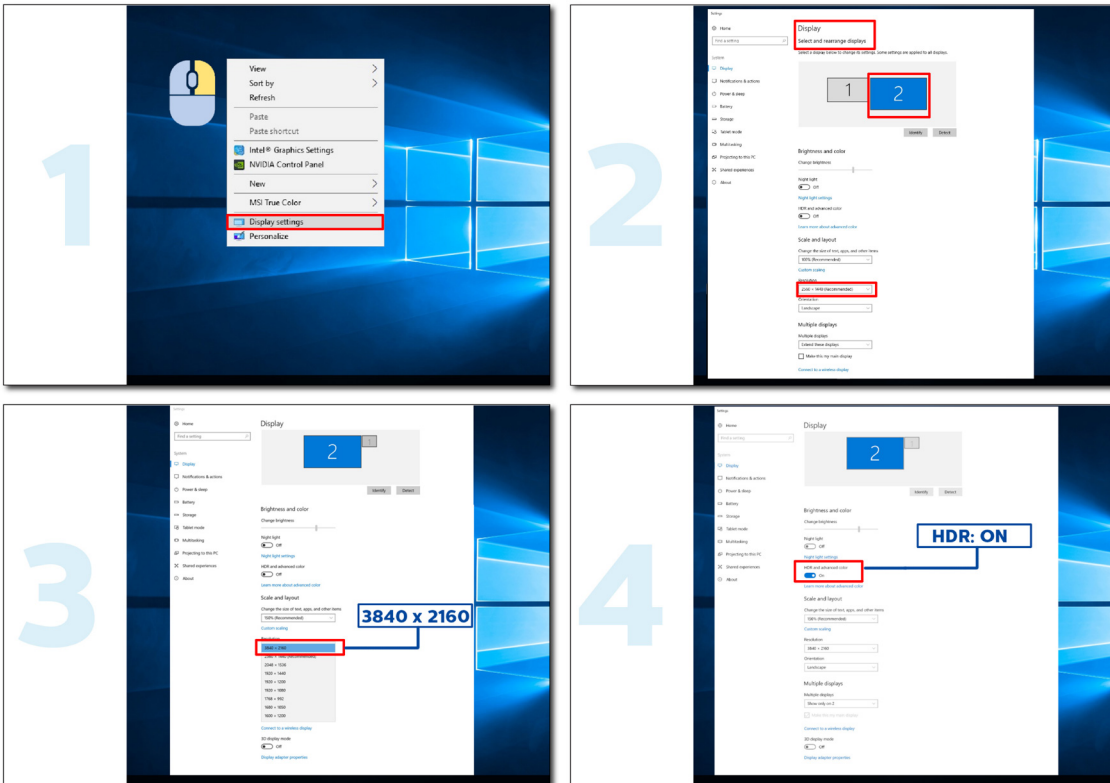

KVM

This product supports the KVM feature.

In the full-screen display state, you can control two signal output devices (two computers, or two laptops, or one computer and one laptop) with a keyboard and mouse set through the KVM feature.

Setup steps:

1. Use the USB-C to USB-C cable to connect the monitor to the first device (computer or laptop) through the USB-C1 connector.
2. Connect the monitor to the second device (computer or laptop) through the HDMI or DisplayPort (input) connector, and connect the USB-C2 of the monitor to the USB connector of the device using the USB-C to USB-A cable.
3. Connect the peripheral devices (keyboard and mouse) to the USB-A (USB downstream) connector of the monitor.

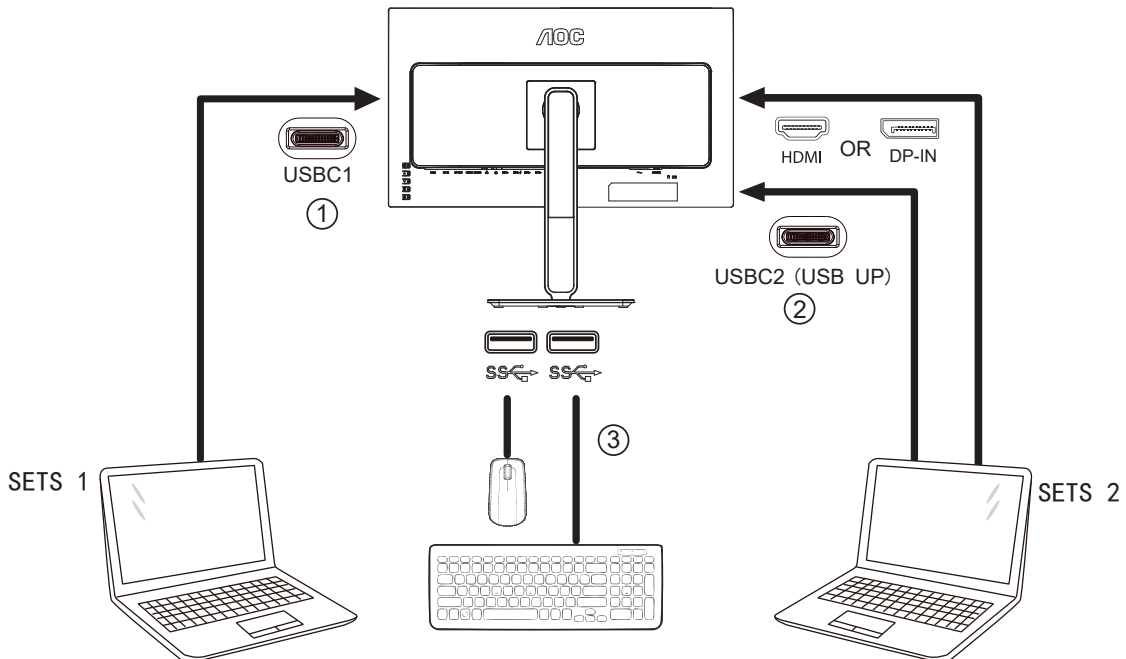

4. Go to the OSD menu. Set Auto, USB-C1 or USB-C2 in OSD Setup -> USB Selection respectively when needed. If it is set to Auto, the keyboard and mouse connected to the monitor will automatically switch the controlled devices according to the displayed signal source.

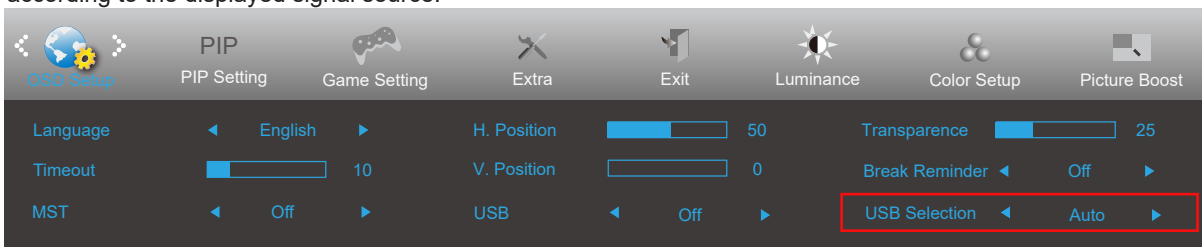

USB Selection	Function description
Auto	Automatically select USB-C1 or USB-C2 (USB upstream), depending on the signal source currently displayed on the screen.
USB-C1	USB upstream path is provided through the The USB-C to USB-C cable.
USB-C2	The USB upstream path is provided through the USB-C to USB-A cable.

Note: In PIP/PBP display mode, please switch the USB upstream path through the OSDmenu.

Adjusting

Hotkeys

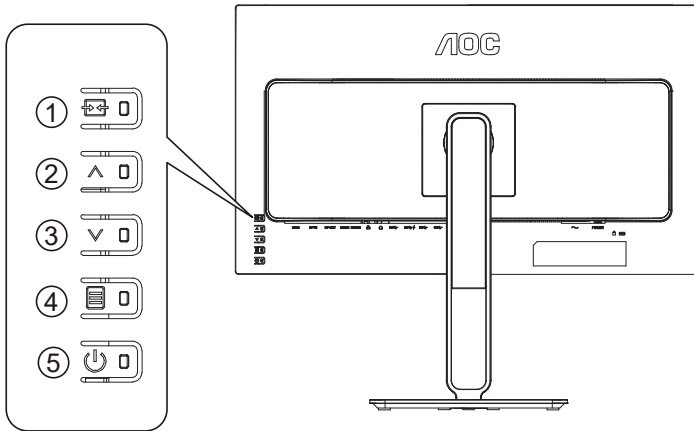

1	Source/Exit
2	Volume/Λ
3	DisplayPort MST/V
4	Menu/Select
5	Power

Power

Press the power key to turn on/off the monitor.

Menu/Select

When the OSD menu is closed, press this button to activate the OSD menu or confirm the function adjustment.

Volume / increase

When the OSD menu is closed, press the “Λ” key to open the volume adjustment bar, and press the “Λ” or “V” key to adjust the headphone output volume.

Source switching/exit

When the OSD menu is off, press this key to activate the signal source switching function, press this key continuously to select the signal source displayed in the information bar, and press the menu key to adjust to the selected signal source. When the OSD menu is active, this button acts as an exit key (to exit the OSD menu)

DisplayPort MST/Minus

When the OSD menu is off, press the “ √ ” button to turn the DisplayPort MST on or off. (If “Input Selection” in the OSD menu is “Auto” or “HDMI”, the MST feature is Off by default and cannot be adjusted.)

OSD Setting

Basic and simple instruction on the control keys.

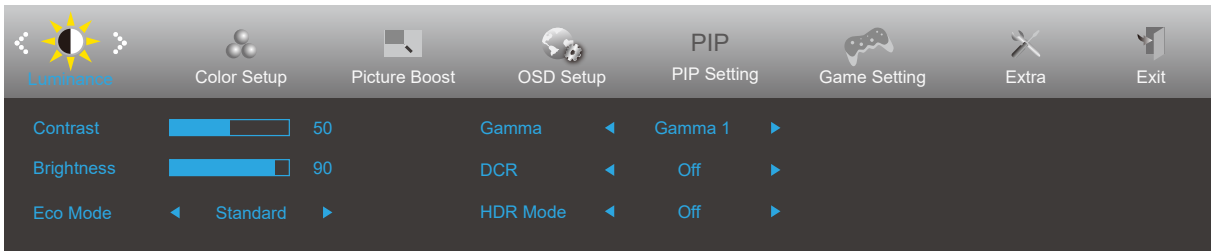







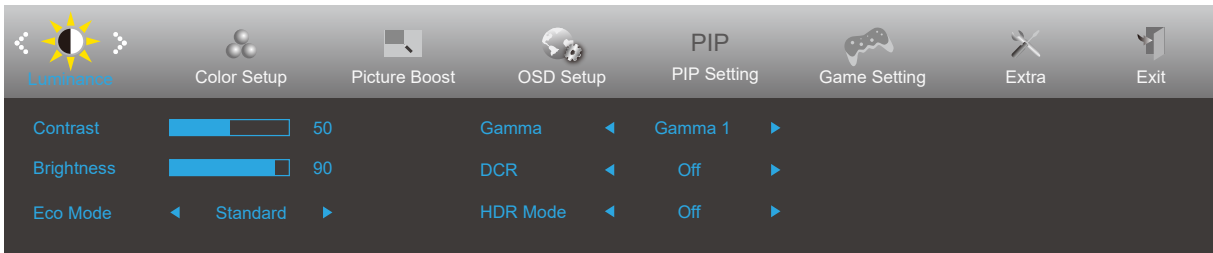

- 1). Press the **MENU-button** to activate the OSD window.
- 2). Press **V** or **Λ** to navigate through the functions. Once the desired function is highlighted, press the **MENU-button** to activate it, press **V** or **Λ** to navigate through the sub-menu functions. Once the desired function is highlighted, press **MENU-button** to activate it.
- 3). Press **V** or **Λ** to change the settings of the selected function. Press **AUTO-button** to exit. If you want to adjust any other function, repeat steps 2-3.
- 4). OSD Lock Function: To lock the OSD, press and hold the **MENU-button** while the monitor is off and then press **power button** to turn the monitor on. To un-lock the OSD - press and hold the **MENU-button** while the monitor is off and then press **power button** to turn the monitor on.

Notes:

- 1). If the product has only one signal input, the item of "Input Select" is disable to adjust.
- 2). If the screen size of the product is 4:3 or the input signal resolution is the native resolution, then the item "Image Ratio" is invalid.
- 3). The four states of ECO mode (except standard mode), DCR, DCB mode and window highlight can only display one state at a time.

Luminance



	Contrast	0-100		Contrast from Digital-register.
	Brightness	0-100		Backlight Adjustment
	Eco mode	Standard	<input checked="" type="checkbox"/>	Standard Mode
		Text		Text Mode
		Internet		Internet Mode
		Game		Game Mode
		Movie		Movie Mode
		Sports		Sports Mode
		Reading		Reading Mode
		Uniformity	Uniformity Mode	
	Gamma	Gamma1	Adjust to Gamma 1	
		Gamma2	Adjust to Gamma 2	
		Gamma3	Adjust to Gamma 3	
	DCR	Off	<input type="checkbox"/>	Disable dynamic contrast ratio
		On	<input checked="" type="checkbox"/>	Enable dynamic contrast ratio
	HDR	Off	Set the HDR profile according to your usage requirements. Note: When HDR is detected, the HDR option is displayed for adjustment.	
		DisplayHDR		
		HDR Picture		
		HDR Movie		
		HDR Game		
HDR Mode	Off	Optimized for the color and contrast of the picture, which will simulate showing the HDR effect. Note: When HDR is not detected, the HDR Mode option is displayed for adjustment.		
	HDR Picture			
	HDR Movie			
	HDR Game			

Note:

When “HDR Mode” is set to “non-off” , the items “Contrast” , “Eco mode” , “Gamma” cannot be adjusted.

When “HDR Mode” is set to “non-off” , the items “Contrast” , “Brightness” , “ Eco mode” , “Gamma” , “DCR” cannot be adjusted.

When the Color Space under Color Settings is set to sRGB or DCI-P3, the items Contrast, Brightness Scenario Mode, Gamma, and HDR/HDR Mode cannot be adjusted.

Color Setup

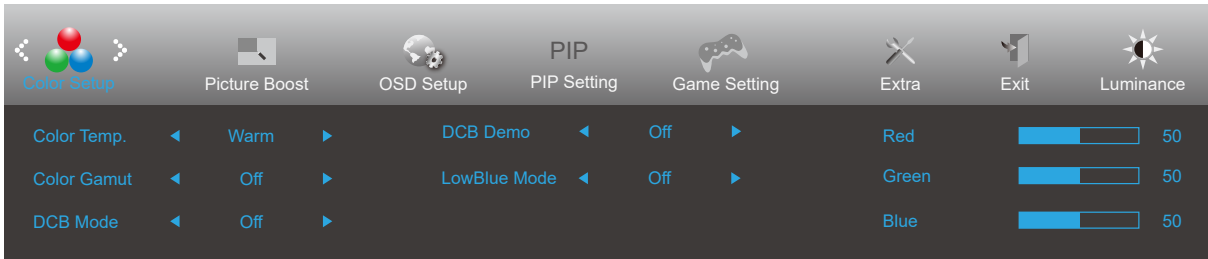

	Color Temp.	Warm	Recall Warm Color Temperature from EEPROM.
		Normal	Recall Normal Color Temperature from EEPROM.
		Cool	Recall Cool Color Temperature from EEPROM.
		User	Red Gain from Digital-register Green Gain Digital-register. Blue Gain from Digital-register
	Color Gamut	Panel Native	Standard color space panel.
		sRGB	Recall sRGB Color Temperature from EEPROM.
		DCI-P3	DCI-P3 color space.
	DCB Mode	Full Enhance	Disable or Enable Full Enhance Mode
		Nature Skin	Disable or Enable Nature Skin Mode
		Green Field	Disable or Enable Green Field Mode
		Sky-blue	Disable or Enable Sky-blue Mode
		Auto Detect	Disable or Enable AutoDetect Mode
		OFF	Disable or Enable OFF Mode
	DCB Demo	on or off	Disable or Enable Demo
	LowBlue Mode	Multimedia	Decrease blue light wave by controlling color temperature
		Internet	
		Office	
Reading			
Off			
Red	0-100	Red gain from Digital-register.	
Green	0-100	Green gain from Digital-register.	
Blue	0-100	Blue gain from Digital-register.	

Note:

When “HDR Mode” or “HDR” under “Luminance” is set to “non-off” , all items under “Color Setup” cannot be adjusted.

When Color Space is set to sRGB or DCI-P3, all other items under Color Settings cannot be adjusted.

Picture Boost





	Bright Frame	on or off	Disable or Enable Bright Frame
	Frame Size	14-100	Adjust Frame Size
	Brightness	0-100	Adjust Frame Brightness
	Contrast	0-100	Adjust Frame Contrast
	H. position	0-100	Adjust Frame horizontal Position
	V. position	0-100	Adjust Frame vertical Position
	Clean Vision	off / Strong / Medium / Weak	Improve picture clarity and brightness

Note:

When “HDR Mode” or “HDR” under “Luminance” is set to “non-off” , all items under “Picture Boost” cannot be adjusted.

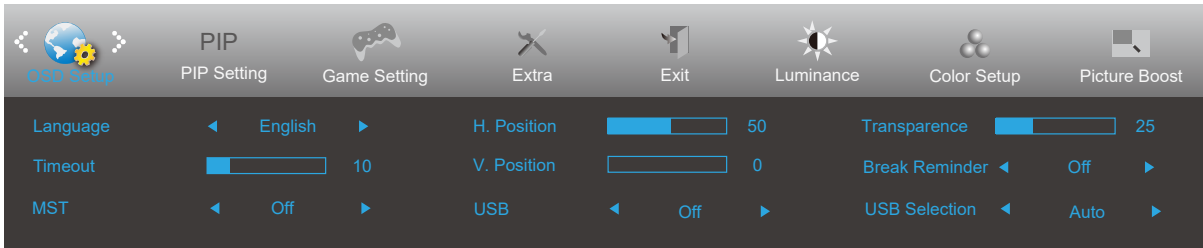
OSD Setup



	Language		Select the OSD language.
	Timeout	5-120	Adjust the OSD Timeout.
	MST*	on or off	Turn the DisplayPort multi-stream transport (MST) mode on or off. When turned on, multiple monitors can be daisy-chained through a DP (output) connector.
	H. Position	0-100	Adjust the horizontal position of OSD.
	V. Position	0-100	Adjust the vertical position of OSD.
	USB	Off /High-Res./ High-Speed	Turn the USB function off or set the USB connector data transmission priority or resolution priority.
	Transparence	0-100	Adjust the transparence of OSD.
	Break Reminder	on or off	Break reminder if the user continuously work for more than 1hrs.
USB Selection	Auto/ USB C1 / USB C2	Select the USB upstream data path.	

Note:

*: DP multi-stream transport (MST) mode must use a graphics card supporting DSC. When the input signal source is DP or USB-C1, MST is automatically turned on. When PIP/PBP is turned on, MST is turned off by default and cannot be adjusted.

PIP Setting

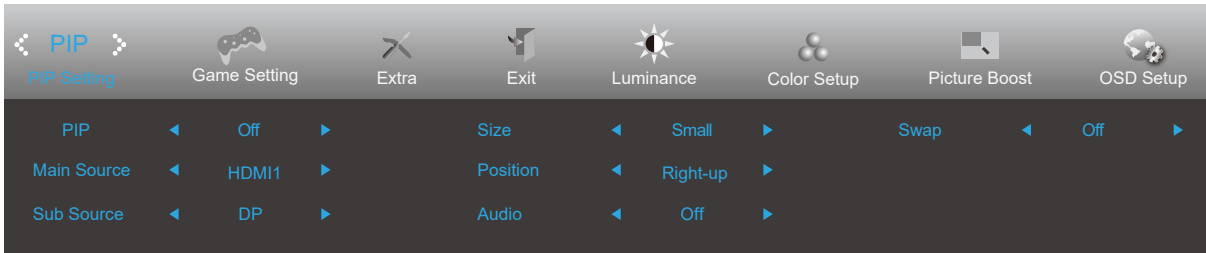

PIP	PIP Setting	OFF / PIP / PBP	Disable or Enable PIP or PBP.
	Main Source		Select main screen source.
	Sub Source		Select sub screen source.
	Size	Small / Middle / Large	Select screen size.
	Position	Right-up	Set the screen location.
		Right-down	
		Left-up	
		Left-down	
	Audio	On: PIP Audio	Disable or Enable Audio Setup.
		Off: Main Audio	
Swap	On: Swap	Swap the screen source.	
	Off: non action		

Note:

When PBP/PIP is turned on, the main source/sub-source input compatibility is as follows:

PIP/PBP		Main source		
		HDMI	USB C1	DisplayPort
Sub sources	HDMI	V	V	V
	USB C1	V	V	V
	DisplayPort	V	V	V

When PIP/PBP is turned on, some color-related adjustments in the OSD menu are only effective for the main picture, but not for the sub-picture. Therefore, the main picture and the sub-picture may have different colors.

Game Setting

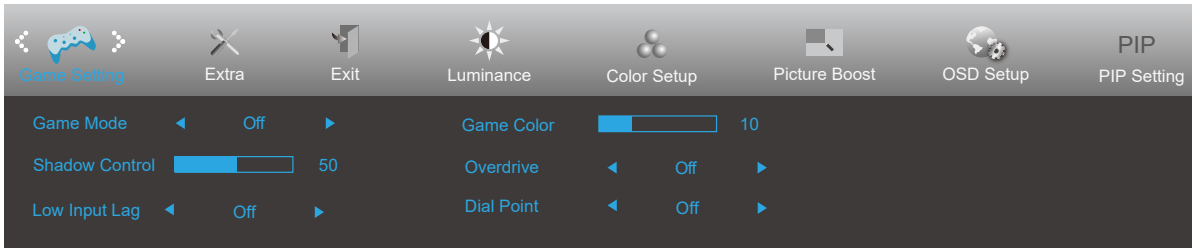

	Game Mode	FPS	For playing FPS (First Person Shooters) games. Improves dark theme black level details.
		RTS	For playing RTS (Real Time Strategy). Improves the image quality.
		Racing	For playing Racing games, Provides fastest response time and high color saturation.
		Gamer 1	User's preference settings saved as Gamer 1.
		Gamer 2	User's preference settings saved as Gamer 2.
		Gamer 3	User's preference settings saved as Gamer 3.
		off	No optimization by Game Mode
	Shadow Control	0-100	Shadow Control Default is 50, then end-user can adjust from 50 to 100 or 0 to increase contrast for clear picture. 1. If picture is too dark to be saw the detail clearly, adjusting from 50 to 100 for clear picture. 2. If picture is too white to be saw the detail clearly, adjusting from 50 to 0 for clear picture
	Low Input Lag	On/Off	Turn off frame buffer to decrease input lag
	Game Color	0-20	Game Color will provide 0-20 level for adjusting saturation to get better picture.
Overdrive	Weak	Adjust the response time.	
	Medium		
	Strong		
	Off		
Dial Point	On/Off	The "Dial Point" function places an aiming indicator in the center of screen for helping gamers to play First Person Shooter (FPS) games with an accurate and precise aiming.	

Note:

When HDR Mode or HDR under Brightness is set to a non-off state, the items Game Mode, Dark Field Control, and Game Tone under Game Settings cannot be adjusted.

When the Color Space under Color Settings is set to sRGB or DCI-P3, the items Game Mode, Dark Field Control, and Game Tone cannot be adjusted.

Extra

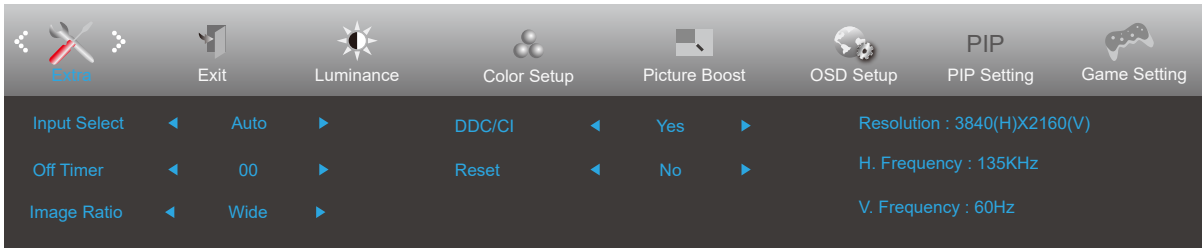

	Input Select	Auto/HDMI/DP/USB C1*	Select Input Signal Source
	Off timer	0-24hrs	Select DC off time
	Image Ratio	Wide	Select image ratio for display.
		4:3	
		1:1	
		Movie1	
		Movie2	
DDC/CI	yes or no	Turn ON/OFF DDC/CI Support	
Reset	ENERGY STAR® or No	Reset the menu to default (ENERGY STAR® available for selective models)	

Note:

*: The device should support USB-C (DisplayPort Alt) function.

When it is used for the first time or after an OSD menu reset operation, the USB function is off by default, and the USB-C cannot supply power. It can be turned on again in any of the following ways:

- 1) The monitor is turned on and off 2 times.
- 2) Set the USB option under OSD Settings in the OSD menu to the non-off state.

Exit

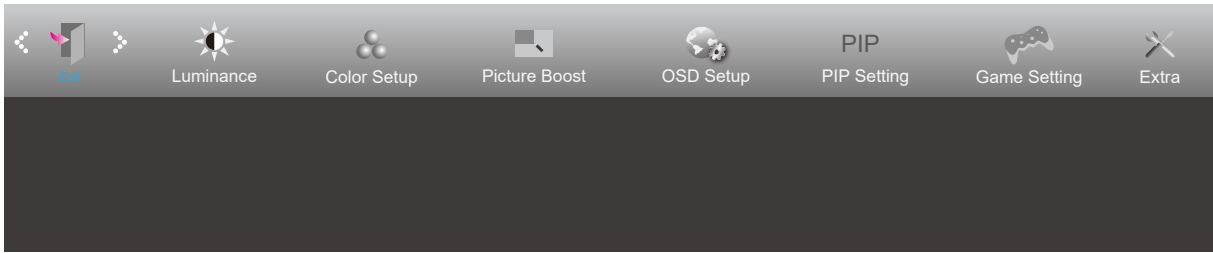

	Exit		Exit the main OSD
---	------	--	-------------------

LED Indicator

Status	LED Color
Full Power Mode	White
Active-off Mode	Orange

Troubleshoot

Problem & Question	Possible Solutions
Power LED Is Not ON	Make sure the power button is ON and the Power Cord is properly connected to a grounded power outlet and to the monitor.
No images on the screen	<ul style="list-style-type: none"> • Is the power cord connected properly? Check the power cord connection and power supply. • Is the video cable connected correctly? (Connected using the VGA cable) Check the VGA cable connection. (Connected using the HDMI cable) Check the HDMI cable connection. (Connected using the DP cable) Check the DP cable connection. * VGA/HDMI/DP input is not available on every model. • If the power is on, reboot the computer to see the initial screen (the login screen.) If the initial screen (the login screen) appears, boot the computer in the applicable mode (the safe mode for Windows 7/8/10) and then change the frequency of the video card. (Refer to the Setting the Optimal Resolution) If the initial screen (the login screen) does not appear, contact the Service Center or your dealer. • Can you see "Input Not Supported" on the screen? You can see this message when the signal from the video card exceeds the maximum resolution and frequency that the monitor can handle properly. Adjust the maximum resolution and frequency that the monitor can handle properly. • Make sure the AOC Monitor Drivers are installed.
Picture Is Fuzzy & Has Ghosting Shadowing Problem	Adjust the Contrast and Brightness Controls. Press hot-key (AUTO) to auto-adjust.(Available for selective models) Make sure you are not using an extension cable or switch box. We recommend plugging the monitor directly to the video card output connector on the back.
Picture Bounces, Flickers Or Wave Pattern Appears In The Picture	Move electrical devices that may cause electrical interference as far away from the monitor as possible. Use the maximum refresh rate your monitor is capable of at the resolution you are using.
Monitor Is Stuck In Active Off-Mode"	The Computer Power Switch should be in the ON position. The Computer Video Card should be snugly fitted in its slot. Make sure the monitor's video cable is properly connected to the computer. Inspect the monitor's video cable and make sure no pin is bent. Make sure your computer is operational by hitting the CAPS LOCK key on the keyboard while observing the CAPS LOCK LED. The LED should either turn ON or OFF after hitting the CAPS LOCK key.
Missing one of the primary colors (RED, GREEN, or BLUE)	Inspect the monitor's video cable and make sure that no pin is damaged. Make sure the monitor's video cable is properly connected to the computer.
Screen image is not centered or sized properly	Adjust H-Position and V-Position or press hot-key (AUTO).
Picture has color defects (white does not look white)	Adjust RGB color or select desired color temperature.
Horizontal or vertical disturbances on the screen	Use Windows 7/8/10/11 shut-down mode to adjust CLOCK and FOCUS. Press hot-key (AUTO) to auto-adjust. (Available for selective models)
Regulation & Service	Please refer to Regulation & Service Information which is in the CD manual or www.aoc.com (to find the model you purchase in your country and to find Regulation & Service Information in Support page.

Specification

General Specification

Panel	Model name	U27U2DP	
	Driving system	TFT Color LCD	
	Viewable Image Size	68.5 cm diagonal	
	Pixel pitch	0.1554mm(H) x 0.1554mm(V)	
	Display Color	1.07B Colors *	
Others	Horizontal scan range	30k-140kHz	
	Horizontal scan Size(Maximum)	596.736mm	
	Vertical scan range	23-75Hz	
	Vertical Scan Size(Maximum)	335.664mm	
	Max resolution	3840x2160@60Hz (HDMI,DP,USB C*)	
	Plug & Play	VESA DDC2B/CI	
	Power Source	100-240V~, 50/60Hz, 2.0A	
	Power Consumption	Typical(default brightness and contrast)	30W
Max. (brightness = 100, contrast =100)		≤ 180W	
Standby mode		≤ 0.5W	
USB C1	USB-C1	Double-sided Connectable Plug	
	Ultra-highSpeed	Data And Video Transmission	
	DP	Built-in DP Alt Mode	
	Power Supply	USB PD	
	Maximum Power Supply	Up to 90W*(5V/3A, 9V/3A, 10V/3A, 12V/3A, 15V/3A, 20V/3.25A, 20V/4.5A)	
USB C2	USB-C2	Double-sided Connectable Plug	
	Ultra-highSpeed	Data And Video Transmission	
	Power Supply	USB PD	
	Maximum Power Supply	Up to15W (5V/3A)	
Physical Characteristics	Connector Type	HDMI/DisplayPort/DisplayPort out/USB-C x2/USB-A x4/RJ-45/Earphone	
	Signal Cable Type	Detachable	
Environmental	Temperature	Operating	0°C~ 40°C
		Non-Operating	-25°C~ 55°C
	Humidity	Operating	10% ~ 85% (non-condensing)
		Non-Operating	5% ~ 93% (non-condensing)
	Altitude	Operating	0~ 5000 m (0~ 16404ft)
		Non-Operating	0~ 12192m (0~ 40000ft)

Note:

1). The maximum number of display colors supported by this product is 1.07 billion, and the setting conditions are as follows (there may be differences due to the output limitation of some graphics cards):

Signal Version Color Format State Color Bit	HDMI2.0		DisplayPort1.4		USB-C @USB high data speed	USB-C @USB high resolution	USB-C @USB high data speed	USB-C @USB high resolution
	YCbCr422	YCbCr444	YCbCr422	YCbCr444	YCbCr422		YCbCr444	
	YCbCr420	RGB	YCbCr420	RGB	YCbCr420		RGB	
UHD 60Hz 10 bpc	V	\	V	V	V	V	V	V
UHD 30Hz 10 bpc	V	V	V	V	V	V	V	V
UHD 60Hz 8 bpc	V	V	V	V	V	V	V	V
UHD 30Hz 8 bpc	V	V	V	V	V	V	V	V
Low resolution 8 bpc/10 bpc	V	V	V	V	V	V	V	V

USB-C must use a graphics card that supports DSC. Please consult the graphics card manufacturer for DSC support.

2). The USB-C (DisplayPort Alt) (HBR3) signal is input, and the maximum resolution is 3840×2160@60Hz. When the USB-C (DP Alt) (HBR2) signal is input and the USB is set to High Resolution, the maximum resolution is 3840×2160@60Hz.

3). The multi-function USB-C connector (USB-C1) has a maximum external output power of 90W. The output power may vary due to the usage scene and environment or when connected with different types of laptops. The specific data shall be subject to the actual situation.

See the following table for the influence of the monitor working state on USB-C output power:

HDR/SDR	HDR peak brightness (Typical)	OSD brightness	USB connector power consumption	USB-C1 Maximum output power
HDR	400cd/m ²	-	-	65W
SDR	-	0~70	≤5W	90W
SDR	-	71~100	≤5W	65W
SDR	-	0~100	>5W	65W

Preset Display Modes

STANDARD	RESOLUTION	HORIZONTAL FREQUENCY(+/-1kHz)	VERTICAL FREQUENCY(+/-1Hz)
VGA	640x480@60Hz	31.469	59.94
	640x480@72Hz	37.861	72.809
	640x480@75Hz	37.5	75
SVGA	800x600@56Hz	35.156	56.25
	800x600@60Hz	37.879	60.317
	800x600@72Hz	48.077	72.188
	800x600@75Hz	46.875	75
XGA	1024x768@60Hz	48.363	60.004
	1024x768@70Hz	56.476	70.069
	1024x768@75Hz	60.023	75.029
SXGA	1280x1024@60Hz	63.981	60.02
	1280x1024@75Hz	79.976	75.025
WXGA+	1440x900@60Hz	55.935	59.887
	1440x900@60Hz	55.469	59.901
WSXGA	1680x1050@60Hz	65.29	59.954
	1680x1050@60Hz	64.674	59.883
FHD	1920x1080@60Hz	67.5	60
QHD	2560x1440@60Hz	88.787	59.951
***	1920x2160@60Hz	133.293	59.988
UHD	3840x2160@30Hz	67.5	30
	3840x2160@50Hz	112.5	50
	3840x2160@60Hz	135	60
IBM MODES			
DOS	720x400@70Hz	31.469	70.087
MAC MODES			
VGA	640x480@67Hz	35	66.667
SVGA	832x624@75Hz	49.725	74.551
XGA	1024x768@75Hz	60.241	74.927

Note: According to the VESA standard, there may be a certain error (+/-1Hz) when calculating the refresh rate (field frequency) of different operating systems and graphics cards. In order to improve compatibility, the nominal refresh rate of this product has been rounded off. Please refer to the actual product.

Pin Assignments



19-Pin Color Display Signal Cable

Pin No.	Signal Name	Pin No.	Signal Name	Pin No.	Signal Name
1.	TMDS Data 2+	9.	TMDS Data 0-	17.	DDC/CEC Ground
2.	TMDS Data 2 Shield	10.	TMDS Clock +	18.	+5V Power
3.	TMDS Data 2-	11.	TMDS Clock Shield	19.	Hot Plug Detect
4.	TMDS Data 1+	12.	TMDS Clock-		
5.	TMDS Data 1Shield	13.	CEC		
6.	TMDS Data 1-	14.	Reserved (N.C. on device)		
7.	TMDS Data 0+	15.	SCL		
8.	TMDS Data 0 Shield	16.	SDA		

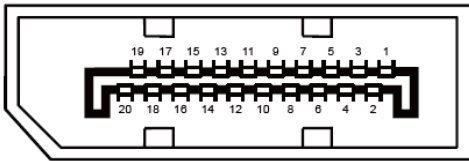

20-Pin Color Display Signal Cable

Pin No.	Signal Name	Pin No.	Signal Name
1	ML_Lane 3 (n)	11	GND
2	GND	12	ML_Lane 0 (p)
3	ML_Lane 3 (p)	13	CONFIG1
4	ML_Lane 2 (n)	14	CONFIG2
5	GND	15	AUX_CH(p)
6	ML_Lane 2 (p)	16	GND
7	ML_Lane 1 (n)	17	AUX_CH(n)
8	GND	18	Hot Plug Detect
9	ML_Lane 1 (p)	19	Return DP_PWR
10	ML_Lane 0 (n)	20	DP_PWR

Plug and Play

Plug & Play DDC2B Feature

This monitor is equipped with VESA DDC2B capabilities according to the VESA DDC STANDARD. It allows the monitor to inform the host system of its identity and, depending on the level of DDC used, communicate additional information about its display capabilities.

The DDC2B is a bi-directional data channel based on the I2C protocol. The host can request EDID information over the DDC2B channel.